

**PUFFIN CROSSING (A1012) BURNHAM ROAD, SOUTH WOODHAM  
FERRERS, CHELMSFORD**

**Statement of Reasons**

A new drive through restaurant (Sui Generis Use comprising both Use Class A3 'Restaurant and Cafe' and Use Class A5 'Hot Food Takeaway') is to be built next to the BP Garage along B1012 Burnham Road. Subsequently, it is expected that there will be an increased amount of pedestrian traffic in the vicinity and therefore the provision of pedestrian crossing on Burnham Road has been conditioned within their planning consent.

Condition 4 of their Planning Consent Reference 18/01910/FUL states: "To make adequate provision within the highway for additional vehicle and pedestrian traffic generated as a result of the proposed development."

The new signalised crossing is proposed to replace an existing uncontrolled pedestrian crossing. Therefore the proposed crossing will provide a more efficient crossing point for pedestrians in this area.

The proposed lengths of the associated zig-zag road markings provide sufficient visibility for vehicles approaching the crossing, allowing them time to adjust their speeds accordingly.

Topographical Survey undertaken by Russell Surveys  
(Drawing no. 165530361)

**NOTES:**

- All details to be checked on-site by the Highway Contractor and the Engineer notified immediately of any discrepancies prior to the commencement of the Works.
- All dimensions shown are in metres unless otherwise stated. **DO NOT SCALE** from this drawing, use figured dimensions only.
- All levels in metres above Ordnance datum unless otherwise stated.
- All materials and workmanship shall comply fully with the Manual of Contract Documents for Highway Works (MCHW) and the Essex County Council Development Construction Manual (Nov 2017).
- No deviation from the details shown on this drawing is permitted without permission from the Engineer or Highway Authority.
- Traffic Signs Management to be in accordance with Chapter 6 of the Traffic Signs Manual and relevant CoDs of Practice.
- Drawing to be read in conjunction with all approved drawings, always Consulting Street Lighting and Signals Designs and the Essex County Council Development Construction Manual (Apr 2020).

**KEY:**



Rev.	Date	Description of revision	Down	Checked	Reviewed	Approved

**DRAWING STATUS**

**CONSULTATION**



Ringway - Jacobs working in partnership with Essex County Council

Mark Rows, Service Director, Essex Highways  
County Hall, Chelmsford, CM1 1QH  
Tel: 0845 8337821

Essex County Council

**SCHEME TITLE**

**NEW PUFFIN CROSSING  
B1012 BURNHAM ROAD  
SOUTH WOODHAM FERRERS**

**DRAWING TITLE**

**PUBLIC CONSULTATION  
PLAN**

DESIGNED	DRAWN	CHECKED	REVIEWED	APPROVED
XX	AD			AH
DATE	DATE	DATE	DATE	DATE
OCT 20	OCT 20		OCT 20	OCT 20

SCALE AT A4 (297x210mm)
NTS

DRAWINGS No.	REV.
<b>DM-298-07-AD</b>	-

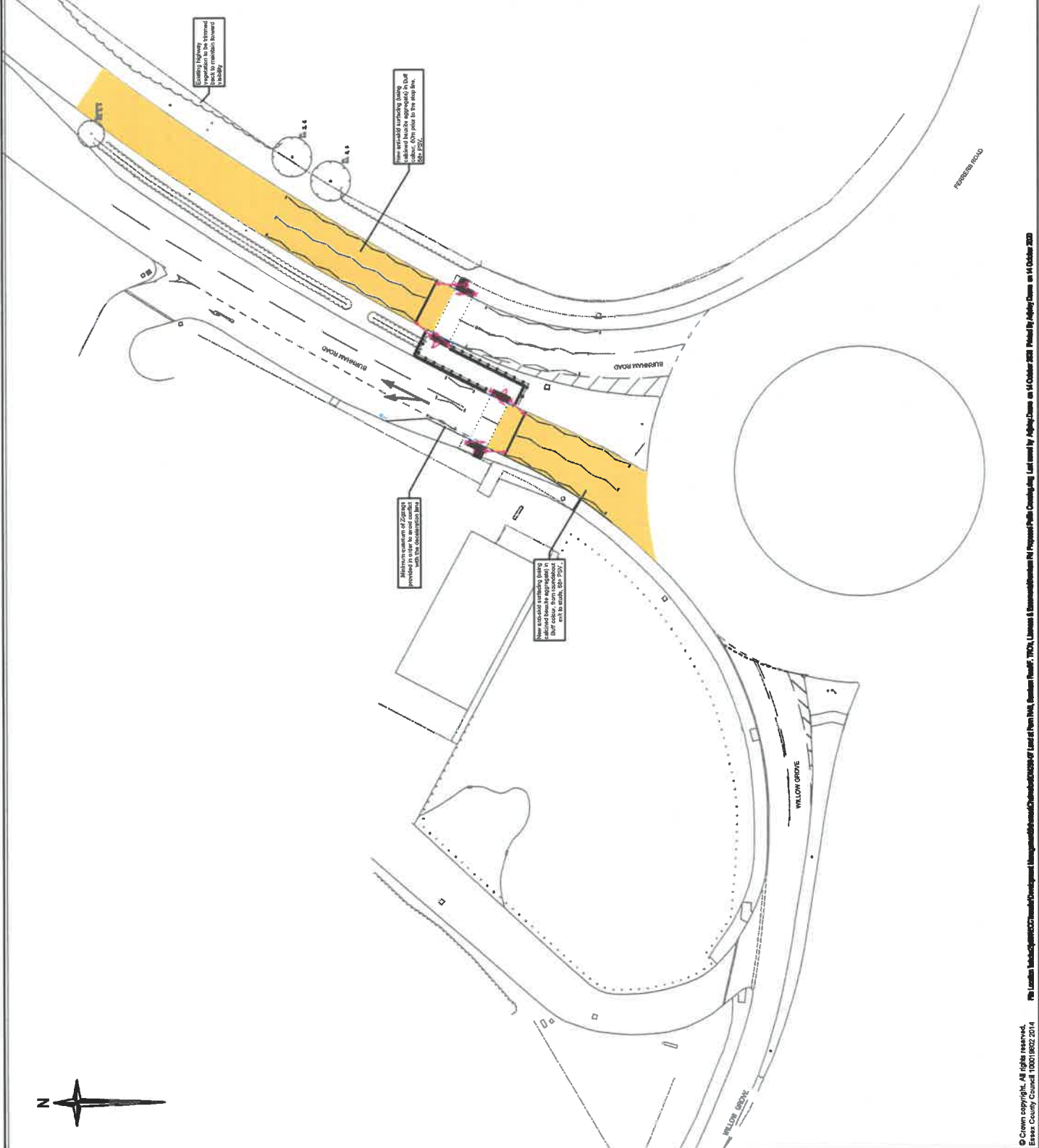

# Public notice

## Installation of Puffin Crossing on B1012 Burnham Road, South Woodham Ferrers, Chelmsford

Notice is hereby given that under Sections 23 of the Road Traffic Regulation Act 1984 the Essex County Council proposes to install a Puffin Crossing on the following length of road:

### Proposed Puffin Crossing

Road	Description
NORTHBOUND CARRIAGEWAY B1012 Burnham Road, South Woodham Ferrers	The centre line of the crossing is located approximately 35 metres northeast of its junction with the Willow Grove/Ferrers Road Roundabout and measures approximately 8.2 metres between give-way lines.
SOUTHBOUND CARRIAGEWAY B1012 Burnham Road, South Woodham Ferrers	The centre line of the crossing is located approximately 42 metres northeast of its junction with the Willow Grove/Ferrers Road Roundabout and measures approximately 8.2 metres between give-way lines.

### Proposed Puffin Crossing Zig-Zags

Road	Description
NORTHBOUND CARRIAGEWAY B1012 Burnham Road, South Woodham Ferrers	<ol style="list-style-type: none"><li>1. From its junction with the southern side of the Puffin Crossing, in a south westerly direction for a distance of approximately 17.5 metres.</li><li>2. From its junction with the northern side of the Puffin Crossing, in a north easterly direction for a distance of approximately 4.5 metres.</li></ol>
SOUTHBOUND CARRIAGEWAY B1012 Burnham Road, South Woodham Ferrers	<ol style="list-style-type: none"><li>1. From its junction with the southern side of the Puffin Crossing, in a southerly direction for a distance of approximately 17.9 metres.</li><li>2. From its junction with the northern side of the Puffin Crossing, in a north easterly direction for a distance of approximately 25.8 metres.</li></ol>

**Further details:** All associated documents for the proposed scheme are available on the Essex Highways website: <http://www.essexhighways.org/Transport-and-Roads/Highway-Schemes-and-Developments/Traffic-Regulation-Orders.aspx> If you need to view a hard copy of these documents please call 07703796401 or 07515999663 to arrange a suitable time to inspect the documents quoting the below reference number. Documents can be made available for inspection 8.30am-5.30pm Mon-Thurs and 8.30am-5pm on Friday at Essex County Council, County Hall E block main reception, Market Road, Chelmsford if so required following the current social distancing restrictions. Alternatively documents can be posted to you upon request.

**Representation:** Anyone who wishes to make a representation about the proposed scheme should send their representation via e-mail to [TrafficRegulation.Order@essexhighways.org](mailto:TrafficRegulation.Order@essexhighways.org) quoting reference TRAF/7403, by 13/11/2020

Dated: 22/10/2020

County Hall  
Chelmsford

Essex County Council  
Network Assurance



Essex County Council

# NOV. 2018 APPLICATION

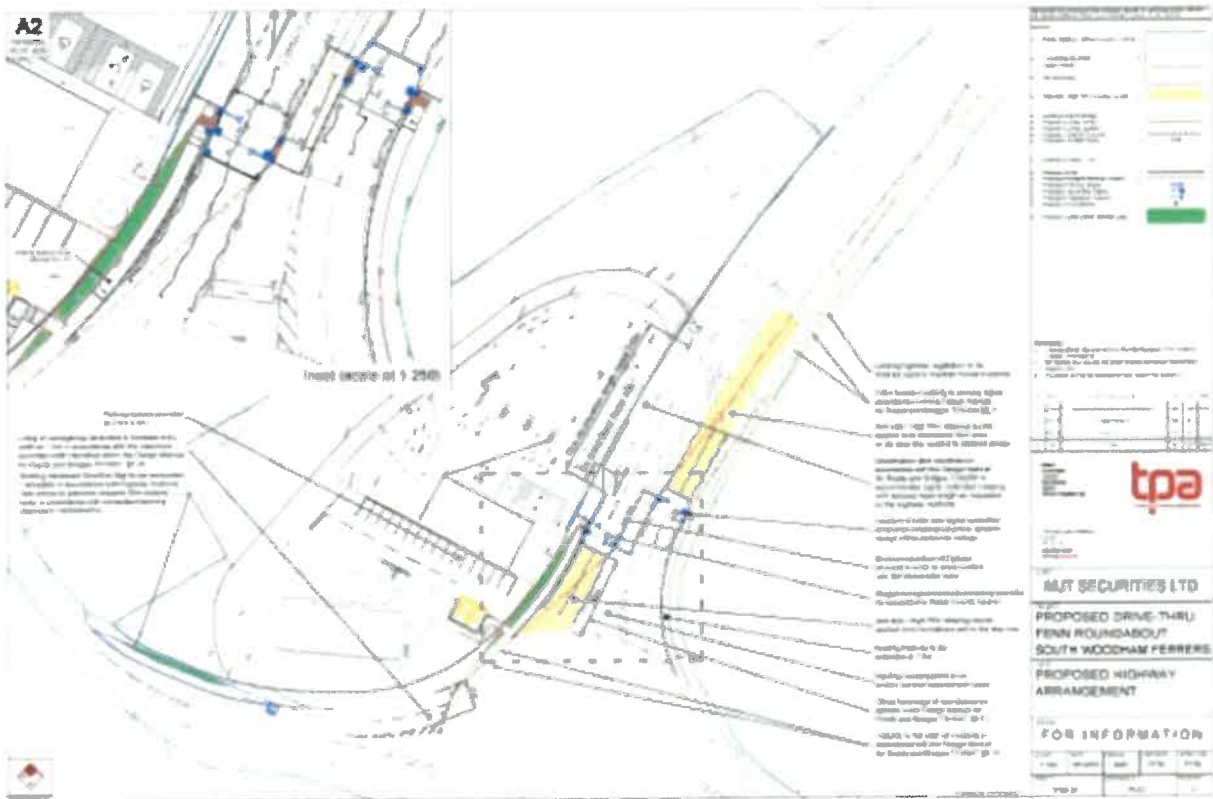



NOV. 2018 PLANNING APPLICATION

